

WORKSHOP MAIN — 23' x 16' CENTRAL WORK ZONE

EQUIPMENT ROOM — ACOUSTIC ISOLATION (LDD-14 SEQ)

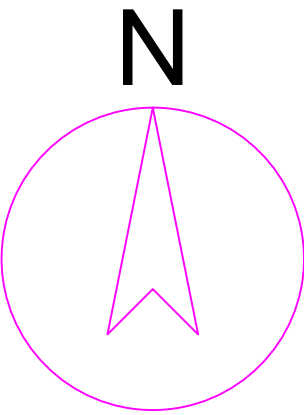

LEGEND

- Dust main + drops
- Pneumatic main + drops
- EMT power + 20A circuits
- Task LED bands
- Transport spine / mat outlines
- Tool drop (dust+air+power)

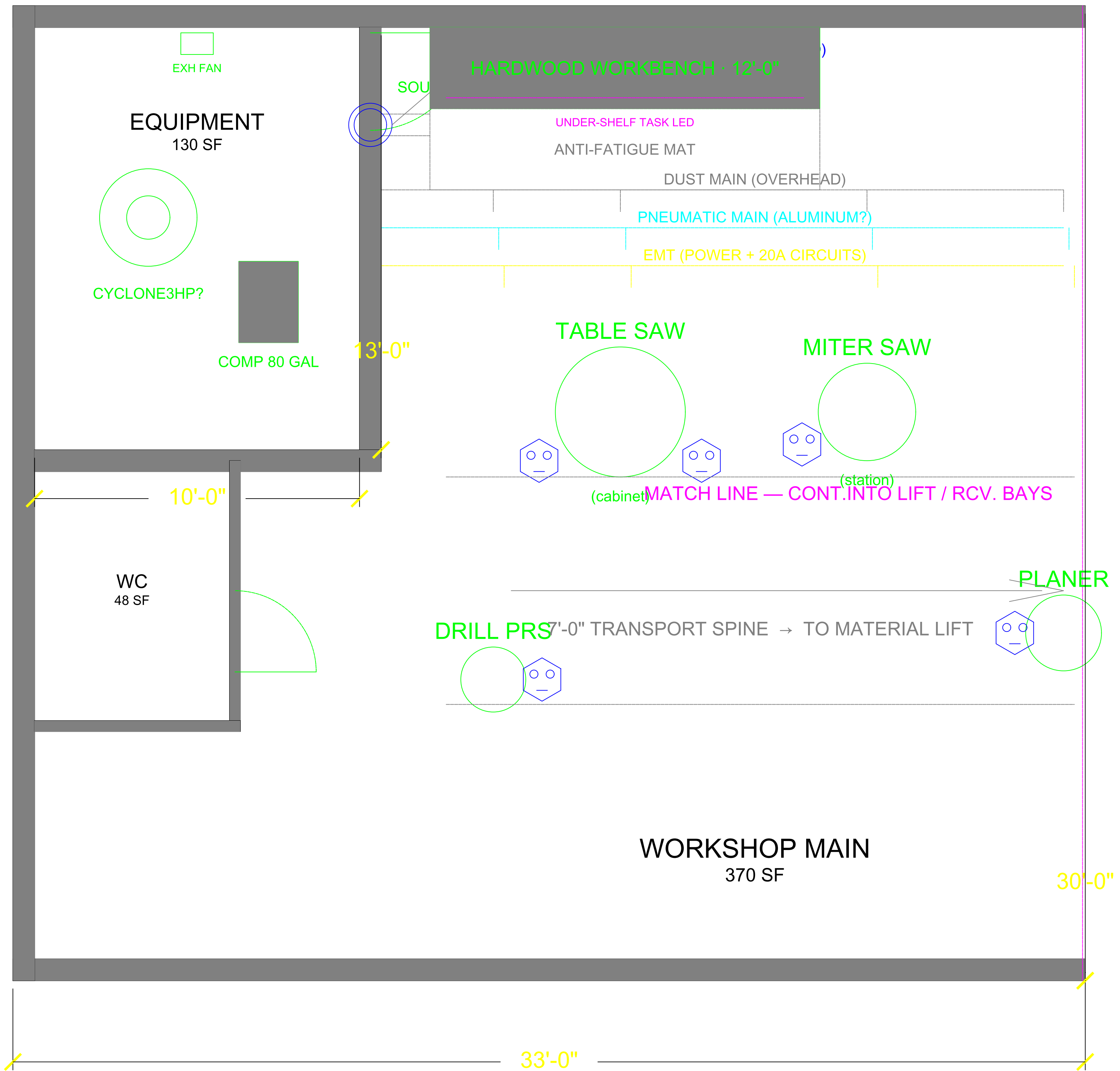

NOTE: Tool drops designed at build time, not retrofit (LDD-14 air-gap #3).
 NOTE: All workshop circuits 20A dedicated; min. 5 outlets/wall (LDD-14 open item).

BARNDOMINIUM
LDD-14 · WORKSHOP + EQUIPMENT PLAN
SHEET A-114 SCALE 1/4" = 1'-0"
2026-05-17 BY SpicyRiceCakes